



Broadwater Rod & Gun Club

PO Box 641, Townsend, MT 59644

Michael Insko
Realty Specialist
BLM Field Office
106 North Parkmont
Butte, MT 59701

July 10, 2020

RE: Additional Land Acquisition Request for the Indian Creek Outdoor Shooting Sports Complex

Dear Mr. Insko:

The Broadwater Rod and Gun Club (BRGC) operates the Indian Creek Outdoor Shooting Sports Complex and leases the property from Broadwater County. The Indian Creek Shooting Sports Complex property was established with a land transfer from the BLM to Broadwater County many years ago.

Since the transfer of the land to Broadwater County, the BRGC membership has increased from 12 active members to over 460 family memberships. In addition to our active members, BRGC provides shooting opportunities on our 5 various shooting venues for many youth (4H) groups, as well as providing local, state, and federal law enforcement organizations a shooting range for their firearm qualifications and training at the Indian Creek Outdoor Shooting Sports Complex.

Currently one of the venues, the Sporting Clays Shotgun Range, presents a location conflict with the safe operation, and the scheduling of the use of the other ranges on the complex. BRGC is requesting a portion of the additional BLM property adjoining our current southeast property line for the future site of the Sporting Clays Shotgun Range venue. This would alleviate this conflict as well as the range scheduling issues to our users. The southeast BLM property adjacent to our current property line is the only viable location to move the Sporting Clays Shotgun Range venue. See the enclosed map of the BRGC Indian Creek Outdoor Shooting Sports Complex.

Your assistance in this matter would be greatly appreciated. Please feel free to contact me with any questions.

Respectfully,

Brad Peck, President and Chief Range Safety Officer

Broadwater Rod and Gun Club, P.O. Box 641, Townsend, Montana 59644
Phone: 406-209-8651

ENCL: Map of the BRGC Indian Creek Outdoor Shooting Sports Complex

Sample/draft of letter to BLM from Commissioners
written by Virgil

William Pendley
BLM
106 N. Parkmont
Butte Mt 59701

This letter is to ask your office to review a scaled down request for BLM property to be used to move the current sporting clays shoot gun range, so it is even with the current firing lines. Broadwater Commissioners have appointed Virgil Binkley as their representative in presenting the request for land transfer. The attached maps show the existing location of the Indian Creek outdoor shooting range. The current land that the Indian Creek Range is located on the BLM deeded to Broadwater County for an outdoor shooting range.

To ensure safe use of the sporting clays range it requires all rifle and pistol ranges be closed. The sporting clays range was built 15 years ago when the range use was small. The Broadwater Rod and Gun club membership has increased to 450 active members.

With the addition of the requested land on the east side of the existing range it will allow all ranges to be active and will not require shutting down any other ranges. The shotgun ranges will be located on the east side of the requested property and shot fall will be inside the boarders of the property. See att. Maps.

A second request is for a 10-acre tract on the main road to the Silos boat launching area.

The request for this land is to locate a building for the Broadwater County Search and Rescue first responder's equipment. Currently the search boat and other equipment is in city limits of Townsend, Montana. To respond to a search call on Canyon Ferry Lake it takes the first responders an hour to move the search boat to the Silos launch ramp. With the expansion of the silos area a satellite fire station is needed to reduce the time the volunteers can respond to a fire more quickly.

Also, to obtain funds for building construction must be on county property.

Our request for the property is to provide a high level of public safety in Broadwater County.

Respectfully commissioners.



Broadwater Rural Fire District
130 South Cedar Street
Townsend, MT 59644-2600

Duck Creek Townsend Rural Toston Radersburg Winston

March 25, 2020

To whom it may concern,

The Broadwater Rural Fire District would like to support the request for a 10 acre parcel of land near the Silos boat ramp. This parcel is located in the NE1/4 of the NE1/4 of Section 34, T. 8N, R. 1E along the Silos Road.

Our long range plans are to establish a water source and possible fire station in this area to help the response time to fires decrease. This would also help the customer's insurance costs to decrease with an established ISO rated water source.

The Fire District is willing to share this property with the County Search and Rescue for storage for their equipment. We are small groups that will work together any way that we can to promote a successful outcome for any incident.

Ed Shindoll
Fire Chief
Broadwater Rural
Fire District

The Broadwater County Search and Rescue ,a division of the county sheriffs office, has been tasked with all rescues not serviced readily by Fire or EMS. Canyon Ferry reservoir is large part of that year round responsibility.

Broadwater County Search and Rescue would like to acquire a parcel of land in the proximity of the Silos Recreation Area boat ramp on Canyon Ferry Lake. Approximately 10 acres at the intersection of highway 287 and Silos Rd. This land would be used for a building to house the lake rescue unit and the ice rescue response unit. Currently this equipment is stored at the Search and rescue Building at 602 North pine in Townsend mt. The Townsend location is over 8 miles from closest boat access. With current traffic conditions this adds 20 or more minutes of response time to any emergency. This is an unacceptable condition. 10% of the population of Broadwater county reside in what is referred to as the Silos area. Correspondingly there are 10% or more of the search and rescue team living in this area available for immediate response, if the equipment is in the vicinity by. If the team needs to come to town to get equipment this doubles response time to over 40 minutes.

The intent of this land acquisition will be to store the required rescue equipment with in 1 mile of the Silos Recreation area boat launch on Broadwater Bay. Response time is a life or death situation on the water or ice.

Ice fishing is very popular on Canyon Ferry. On any weekend there can be several hundred fishermen on the ice. In the event of a person going through the ice, motor skills go away in under 5 minutes. Cognitive skills can last for 12 minutes. Maximum survival time is 40 minutes. With the ice rescue unit located in the vicinity, the chance for survival is greatly improved.

The Silos boat landing services over 60% of the boat launched on Canyon Ferry Lake. Montana fish wildlife and parks usage numbers for 2017, 105327 (2017 mtfwp) fishing days per year. This number does not include recreational boaters, i.e. skiers, kayaking, swimming. Broadwater county has a population of 6100. Tourism in the county 54980 (2017 ittr)

With the recent growth of Broadwater county and the rapid growth in tourism, response time to an emergency is a high priority. Currently the team responds to approx. 15 lake emergencies per year.

The search and rescue motto: **That others may live.**

Thank you for your consideration,

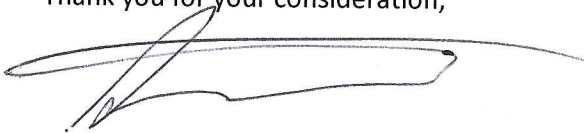
A handwritten signature in black ink, appearing to read 'John Hedstrom', with a long horizontal flourish extending to the right.

John Hedstrom Pres. BCSARA

A Tract of land being all of the W 1/2 of the W 1/2 of Section 22 and that portion of Government Lot 12 and Government Lot 13 of Section 27 situated in the W 1/2 of the W 1/2 of said Section 27 lying north of Indian Creek Road right-of-way, all being in Township 7 North, Range 1 East, P.M.M., Broadwater County, Montana.

Graymont

BLM

BLM

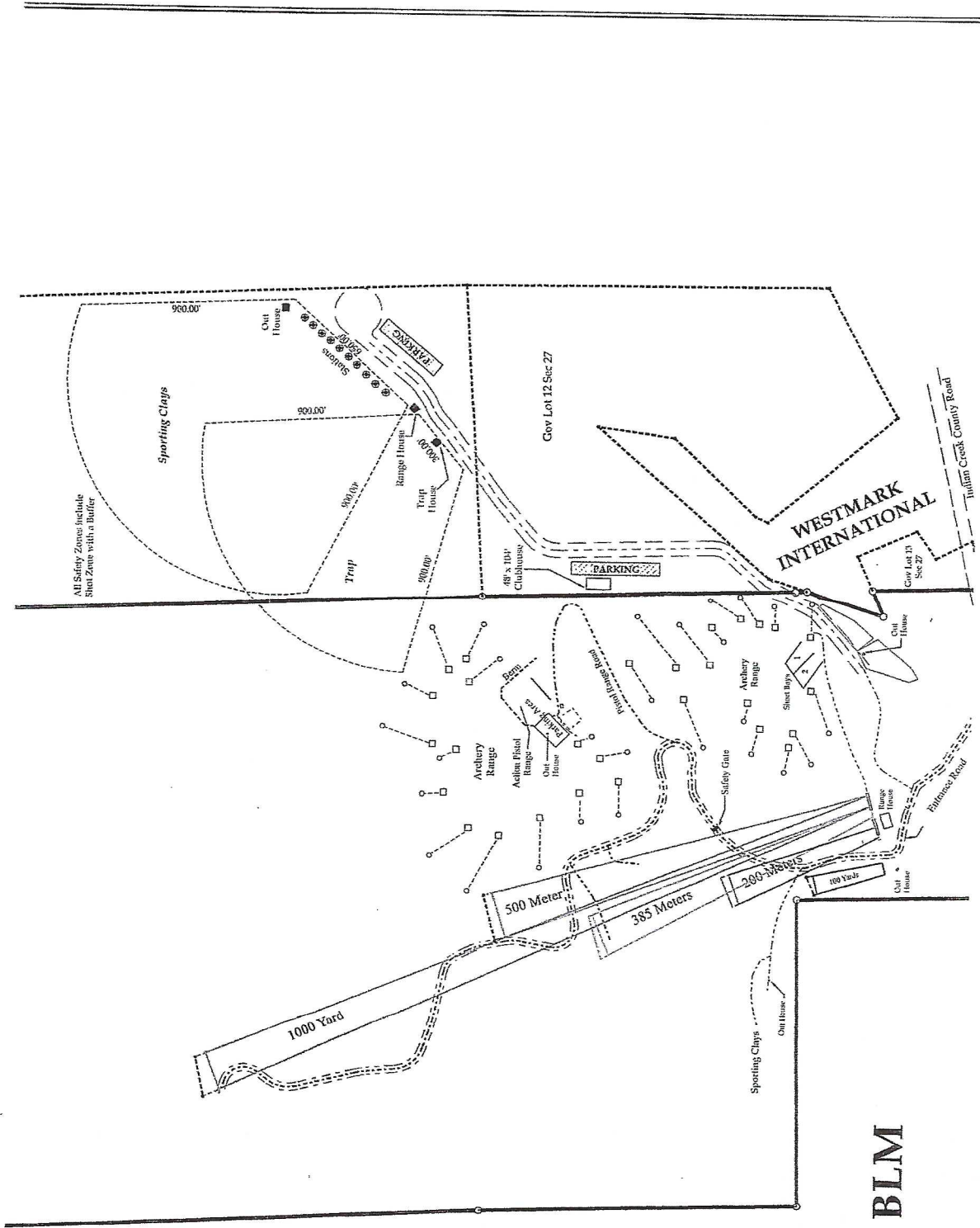

Sec. 21 & 28, T. 7N., R. 1E., Broadwater Co.